

1280

Electronic throttle pedal

▼ This series of plastic floor mounted pedals is intended for any kind of vehicles

A double concentric torsion spring is incorporated for idle position return. Made of polyamide PA66 reinforced with 30% fibreglass, pedal 1280 is very robust and reliable, therefore it can be mounted also on heavy duty construction machines, agriculture machinery or military vehicles. The electronic circuit is fully protected against water and any kind of contaminants. Thanks to its particular enclosure, a high IP is guarantee for the whole pedal and environmental contamination is minimized. Measuring position is through Hall effect sensor with one or two channels. It is available with any kind of electrical interface: 1 or 2 voltage channels, with or without idle validation switch, PWM, current, CANBus. In order to adapt to the most ergonomic position, the paddle can be adjust to different angles (A=): 27°, 36° and 45°. Upon request, pedal 1280 can be equipped with the kick-down option and can be configured with the desired electrical cable length, number of poles, type of connector.

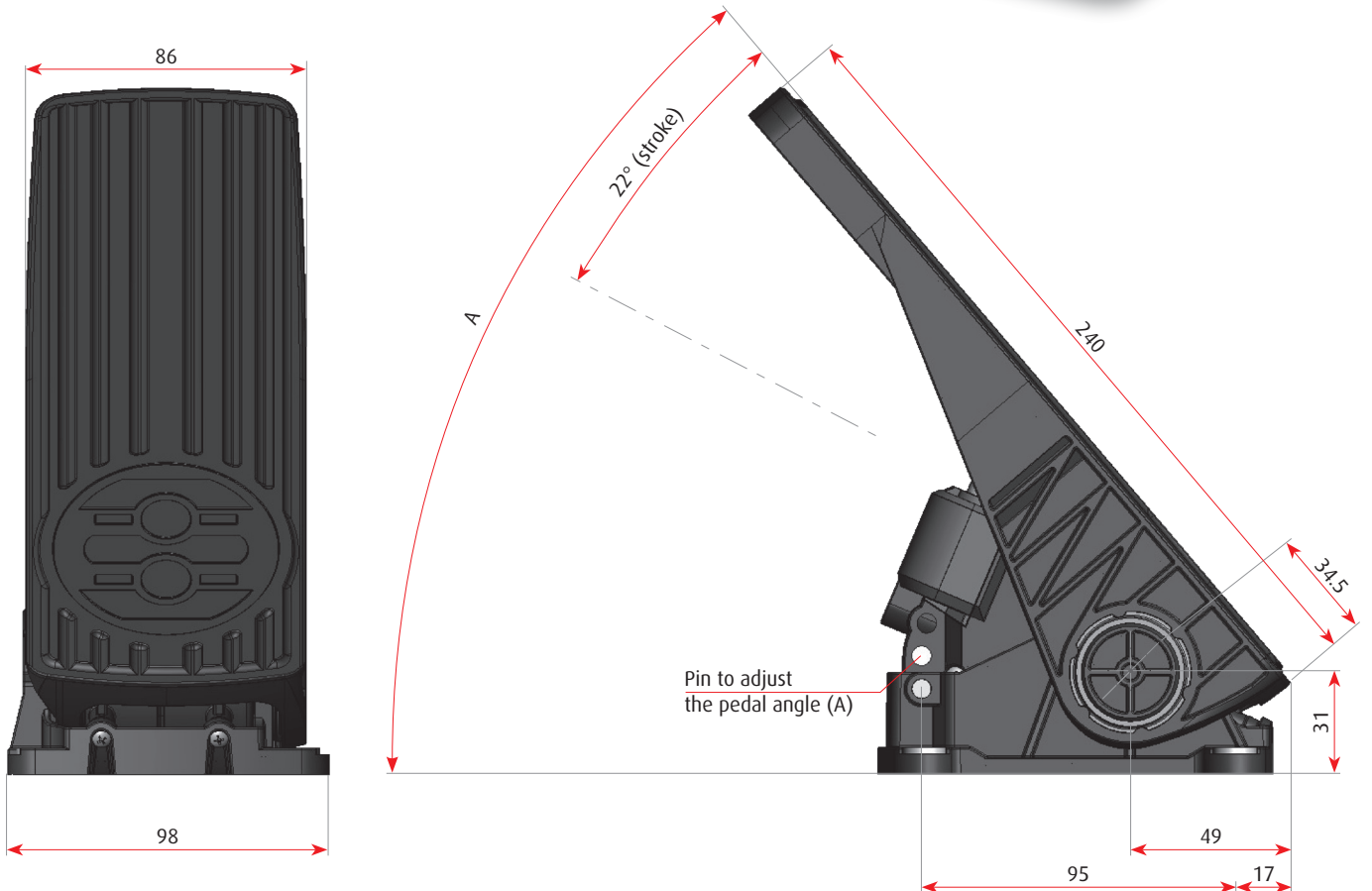

PHYSICAL DIMENSIONS AND MOUNTING INSTRUCTIONS

Adjust the friction of mechanical hysteresis with an hexagonal key of 4 mm. The access is from the bottom of the pedal.

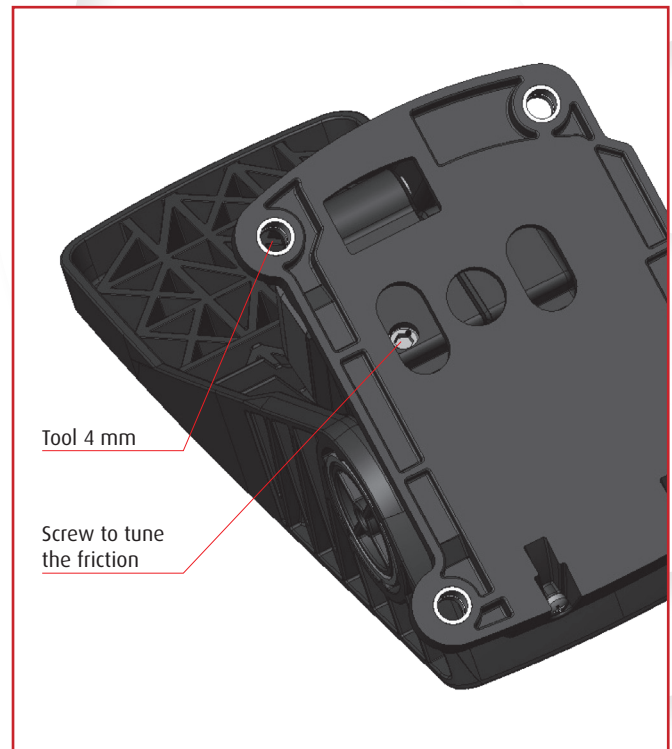
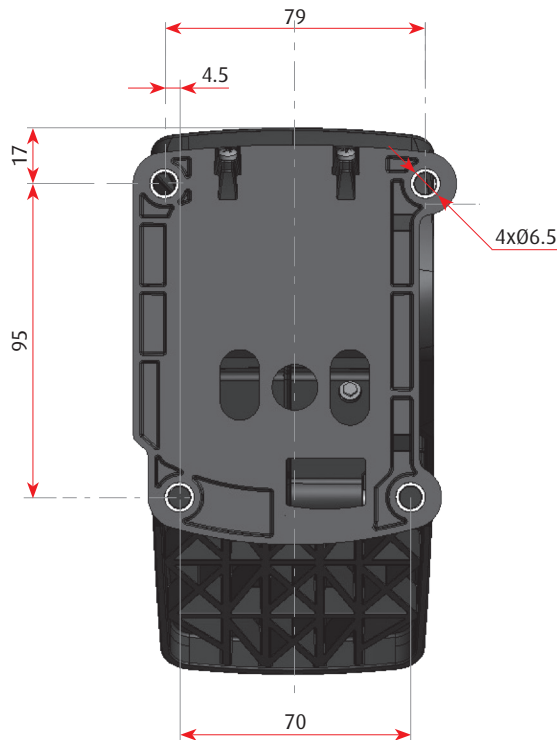

MECHANICAL SPECIFICATION	
• Operational life (at 25 °C)	10 million cycles
• Operating temperature	-40 .. +80 °C
• Storing temperature	-40 .. +110 °C
• Weight	0.80 kg
• Return spring	Double safety spring
• Hysteresis	0.15% on read value
• Travel angle	22 degrees

ELECTRICAL SPECIFICATION (VERSION WITH VOLTAGE SIGNALS)	
• Sensor	Hall effect
• Power supply	5 Vdc ±10% ratio metric
• Electrical signal	Galvanically insulated
• Resolution and update rate	10 bit, update rate 0.1 ms
• Correlation in case of 2 signals	better than 1% in the whole pedal range
• Current consumption	<10 mA (per each channel)
• Minimum load resistance	4.7 kΩ
• Maximum load capacitance	10 nF

APPLICATION EXAMPLE:

PEDAL 1280 WITH 2 VOLTAGE CHANNELS

Here below are reported typical standard configurations of throttle pedals with 1 channel, 2 channels voltage output and 1 channel voltage + 1 Idle Validation Switch. Electrical cable standard length is 0,5 meter but any other length can be defined when ordering. Factory standard connector is AMP Superseal 6 poles but any other connector can be defined when ordering.

INTERFACE CONFIGURATION	CODE	SIGNAL OUTPUT
• 1 channel	1280.01.00	CH1 = voltage signal
• 2 channels	1280.02.00	CH1 = voltage signal; CH2 = voltage signal
• 1 channel + 1 idle validation switch	1280.03.00	CH1 = voltage signal; CH2 = IVS

For a complete overview of Pedal 1280 configured with different possible interfaces, please refer to next section.

Flexball Italiana S.r.l.

Via San Luigi 13/A - 10043 Orbassano (To) - Italy

Tel 0039.011 90.38.900 - Fax 0039.011 90.38.747

info@flexballitaliana.com

www.flexballitaliana.com

FLEXBALL
ITALIANA
WR CONTROLS GROUP

